

DETAIL OF OPENING

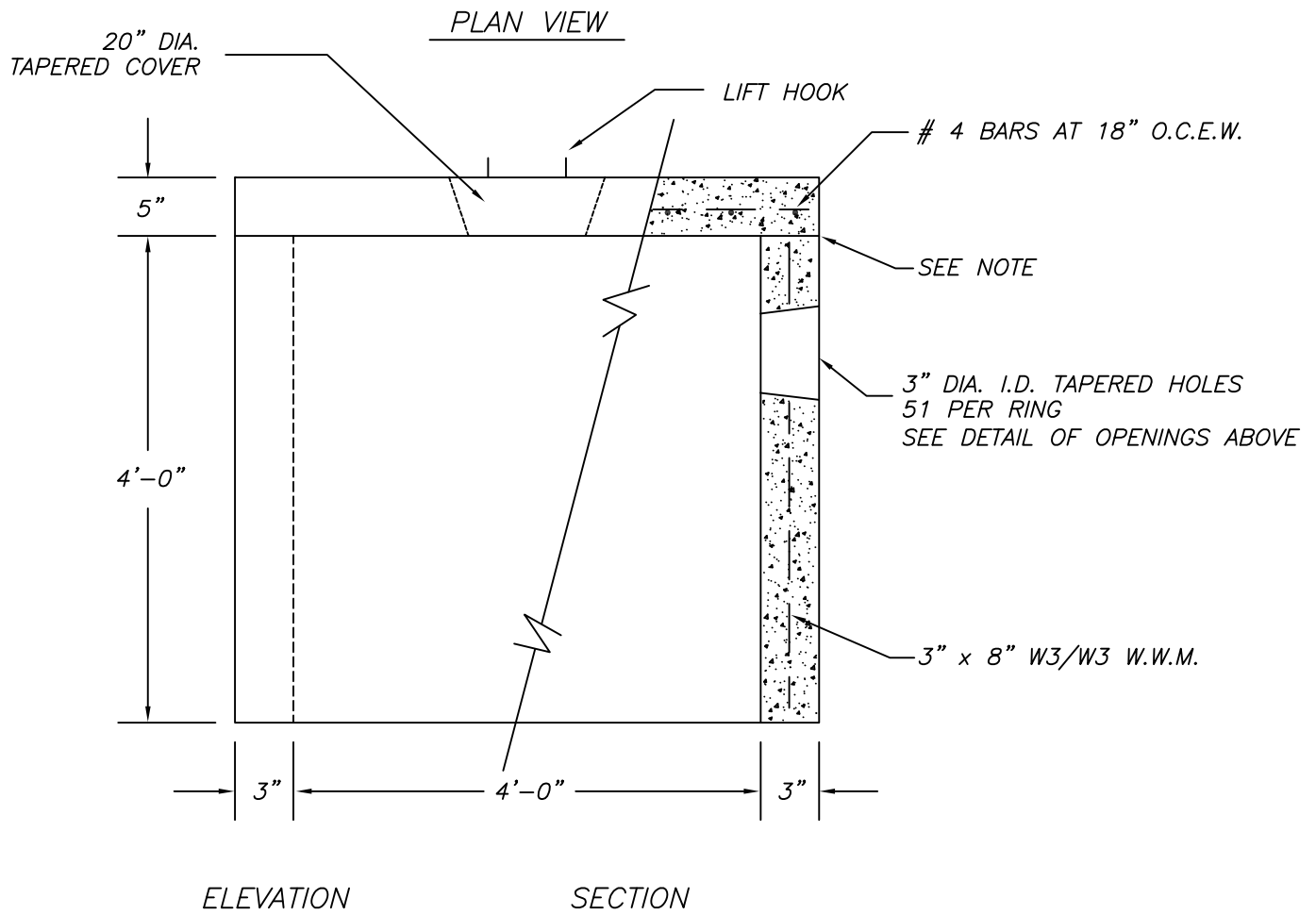

ELEVATION

SECTION

NOTES :

- * CONCRETE TO TEST 4000 PSI @ 28 DAYS
- * WELDED WIRE MESH ASTM-A-185
- * APPROX. WEIGHTS :
FLAT TOP - 1,192 LBS. , RING - 2,000 LBS.
- * 376 GALLON CAPACITY PER RING
- * TRAFFIC TOP AVAILABLE

Precast Concrete Sales Co.		
123 Route 303 Valley Cottage , N.Y. 10989		
Tel. (845) 268-4949 - Fax (845) 268-4376		
CONT.		
JOB		
4'-0" DIA. DRY WELL		
DATE	DRAWN BY	DRAWING NO.
1/16	CLASSIC DESIGN	704